



## AVK FLOATING SURFACE BOX

04/11

Ductile iron

001

AVK offers a very wide range of surface boxes in fixed, floating and height adjustable designs. The surface boxes of cast iron are pre-mounted with a sealing for optimum tightness between lid and body. The large chamber provides easy access for mounting and demounting extension spindles and the closed design protects the extension spindle against sand and dirt.

### Product Description:

Floating surface box

### Standards:

- Designed to all standards

### Features:

- Body of ductile iron
- Lid of grey cast iron
- Lid sealing of NBR rubber
- Epoxy coating to DIN 30677
- Lid inscriptions: "Vand - AVK", "Water - AVK" or "Gas - AVK"

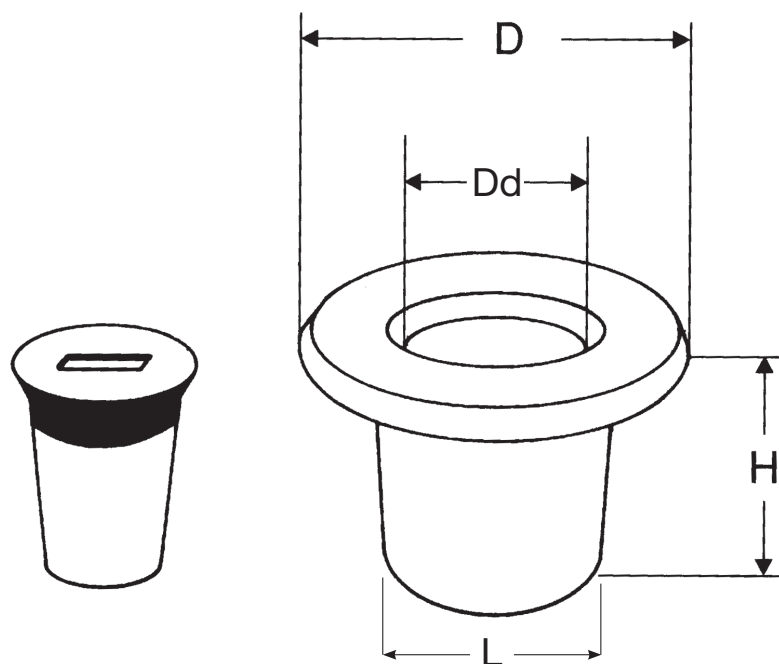

**Component List:**

1. Body	Ductile iron, min. GJS-400-15 (GGG-40)	2. Lid	Grey cast iron, GJL-250 (GG-25)
3. Lid sealing	NBR rubber		

Components may be substituted with equivalent or higher class materials without prior notification.

**Reference Nos. and Dimensions:**

AVK ref. nos	H mm	L mm	D mm	DD mm	Theoretic. weight kg
04-00060-00052-00 <sup>(1)</sup>	130	100	200	80	3.7
04-00060-00069-00 <sup>(2)</sup>	130	100	200	80	3.7
04-00260-00262-00 <sup>(1)</sup>	150	140	240	120	6.4
04-00260-00264-00 <sup>(3)</sup>	150	140	240	120	6.4

<sup>(1)</sup> Lid inscription "VAND - AVK"  
<sup>(2)</sup> Lid inscription "Water - AVK"  
<sup>(3)</sup> Lid inscription "GAS - AVK"