

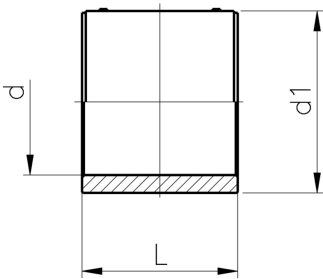

**ELGEF Plus Electrofusion coupler PE100**  
**d355-800mm / SDR17**

- 5 bar Gas / 10 bar Water
- 4 mm pin connectors
- Limited path fusion indicators
- With active reinforcement
- Ø355 – 500 have two connected (monofilar) welding zones (Both pipe ends can be welded simultaneously)
- Ø560 – 800 have two separate (bifilar) welding zones (Both pipe ends welded separately)



d	SDR	PN	DN	Code	Weight	d1	L	SDR pipe
(mm)		(bar)	(mm)		(kg)	(mm)	(mm)	
355	17	10	350	<b>753 911 804</b>	9.522	416	291	17-33
400	17	10	400	<b>753 911 805</b>	13.000	467	295	17-33
450	17	10	450	<b>753 911 806</b>	18.000	526	327	17-33
500	17	10	500	<b>753 911 807</b>	22.000	584	358	17-41
560	17	10	600	<b>753 911 808</b>	34.000	647	396	17-41
630	17	10	600	<b>753 911 809</b>	46.000	727	440	17-41
710	17	10	700	<b>753 911 810</b>	55.600	820	463	17-41
800	17	10	800	<b>753 911 811</b>	73.000	922	484	17-41

The technical data are not binding. They neither constitute expressly warranted characteristics nor guaranteed properties nor a guaranteed durability. They are subject to modification. Our General Terms of Sale apply.

Georg Fischer Piping Systems Ltd, Postfach, CH-8201 Schaffhausen/Switzerland  
 Phone +41 -(0)52-631 1111  
 e-mail: [info.ps@georgfischer.com](mailto:info.ps@georgfischer.com)  
 Internet: <http://www.gfps.com>