

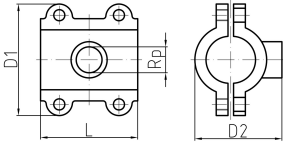

PRIMOFIT Tapping clamp galvanised for steel pipe

Internal thread Rp according to EN 10226-1
* suitable for pipe outer diameter d



Dim. St (inch)	d* (mm)	Dim. Rp (inch)	EPDM Code	SP	GP	Weight (kg)	L (mm)	D1 (mm)	D2 (mm)
½	21.3	½	775 732 051	0	25	0.423	70	67	43
¾	26.9	½	775 732 061	0	30	0.440	70	73	49
1	33.7	½	775 732 062	0	23	0.489	70	80	57
1 ¼	42.4	¾	775 732 065	0	14	0.639	80	94	68
1 ½	48.3	¾	775 732 068	0	10	0.865	100	99	73
2	60.3	1	775 732 073	0	8	1.042	100	114	89

The technical data are not binding. They neither constitute expressly warranted characteristics nor guaranteed properties nor a guaranteed durability. They are subject to modification. Our General Terms of Sale apply.

Georg Fischer Piping Systems Ltd, Postfach, CH-8201 Schaffhausen/Switzerland

Phone +41 -(0)52-631 1111

e-mail: info.ps@georgfischer.com

Internet: <http://www.gfps.com>