

## 26 075 000 EUPHORIA SYSTEM SHOWER SYSTEM WITH THERMOSTATIC MIXER FOR WALL MOUNTING

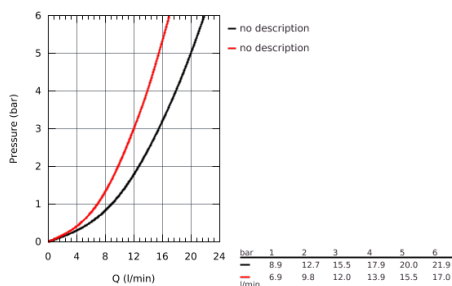

### PRODUCT DESCRIPTION

- consisting of:
- horizontal swivable 450 mm shower arm
- exposed thermostat with Aquadimmer function
- allows change between:
- Rainshower Cosmopolitan 310 metal head shower (27 477 000)
- spray pattern: Rain
- with ball joint
- rotation angle  $\pm 15^\circ$
- hand shower Euphoria 110 Massage (27 221 000)
- adjustable in height with gliding element
- Silverflex shower hose 1750 mm (28 388 000)
- **GROHE TurboStat** compact cartridge with wax thermoelement
- **GROHE SafeStop** at 38°C
- **GROHE SafeStop Plus** optional temperature limiter at 43°C included
- **GROHE DreamSpray** perfect spray pattern
- **GROHE StarLight** chrome finish
- **Inner WaterGuide** for a longer life
- **SpeedClean** anti-lime system
- **Twistfree** to prevent hose from twisting
- **GROHE MetalGrip** ergonomically shaped metal handles
- **suitable for instantaneous heaters from 18 kW/h**
- minimum flow rate 7 l/min.
- min. recommended pressure 1.0 bar
- optional upgrade: GROHE EasyReach tray (26 362)

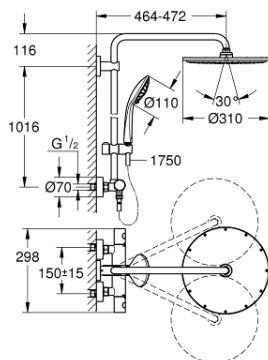

## 26 075 000 EUPHORIA SYSTEM SHOWER SYSTEM WITH THERMOSTATIC MIXER FOR WALL MOUNTING

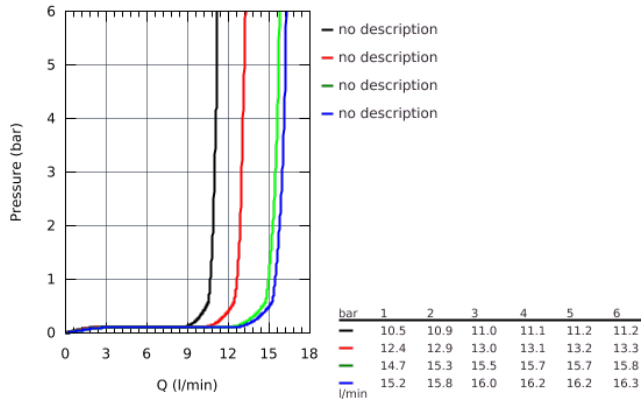

## 26 075 000 EUPHORIA SYSTEM SHOWER SYSTEM WITH THERMOSTATIC MIXER FOR WALL MOUNTING

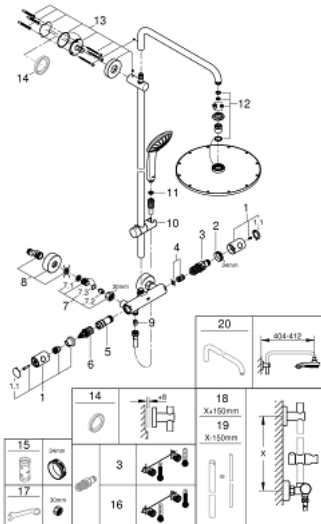

### SPARE PARTS

- 1: Metal handle 1/2" (Order-nr. 47984000)
  - 1.1: Cover cap (Order-nr. 6458500M)
  - 2: Fitting ring (Order-nr. 47743000)
  - 3: Thermostatic compact cartridge 1/2" (Order-nr. 47439000)
  - 4: Buffer (Order-nr. 47398000)
  - 5: Water flow (Order-nr. 47751000)
  - 6: Aquadimmer (Order-nr. 12433000)
  - 7: Non-return valve (Order-nr. 47189000)
  - 7.1: Dirt strainer (Order-nr. 0726400M)
  - 7.2: Non-return valve (Order-nr. 08565000)
  - 7.3: O-ring  $\varnothing 17 \times \varnothing 2$  (Order-nr. 0305500M)
  - 8: S-union (Order-nr. 12662000)
  - 9: Non-return valve (Order-nr. 08565000)
  - 10: Glide element (Order-nr. 12140000)
  - 11: Dirt strainer (Order-nr. 0700200M)
  - 12: Spare part set (Order-nr. 45933000)
  - 13: Shower bar holder (Order-nr. 48279000)
  - 14: Compensation disc (Order-nr. 27180000)\*
  - 15: Socket spanner (Order-nr. 19332000)\*
  - 16: Thermostatic compact cartridge 1/2" for changed waterways (Order-nr. 47175000)\*
  - 17: Special spanner (Order-nr. 19377000)\*
  - 18: Shower system pipe for retrofitting (Order-nr. 48053000)\*
  - 19: Shower system pipe for retrofitting (Order-nr. 48054000)\*
  - 20: Shower arm for shower systems (Order-nr. 14047000)\*
- \* Optional accessories