

## HL310NPr-3000

floor drain DN50/75/110 vertical with trap seal PRIMUS, 121x121mm KLICK-KLACK/115x115mm



floor drain DN50/75/110 vertical with flange, trap seal PRIMUS, cut-to-size grate frame 10 - 80 mm / stainless steel frame KLICK-KLACK 121 x 121 mm, stainless steel grate 115 x 115 mm and supporting frame / cover. Comes with lot cover. System "KLICK-KLACK" - the new arresting system for grates. Loose or lost grates belong to the past. Simply insert the grate into the frame and "click" it in - ready!



### Techn. drawing

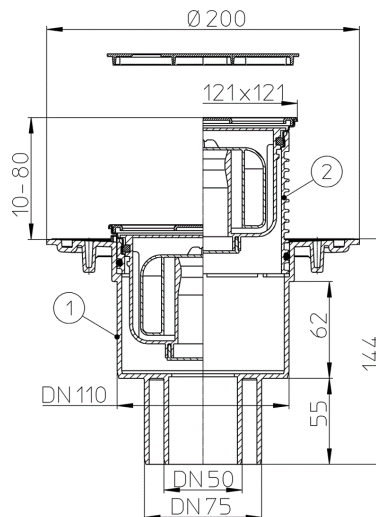

### TECHNICAL DATA

<b>material</b>	PP, PE, Edelstahl	<b>installation height</b>	158 mm
<b>dimension</b>	DN50/75/110	<b>grate frame</b>	10-80 mm/121x121 mm V2A
<b>capacity</b>	0,5 l/s	<b>grate</b>	Edelstahl 115x115 mm

<b>weight</b>	0,74	<b>load class</b>	K3 - 300 kg
<b>EAN</b>	9003076016440	<b>inlet</b>	
		<b>standards</b>	EN1253

## MAIN DATA

### spare parts



#### HL037Pr.1E

Stainless steel grate 115x115mm



#### HL3000Pr

grating d 110mm/stainless steel frame 121x121mm/115x115mm with trap seal PRIMUS. System "KLICK-KLACK". Comes with supporting frame/cover.



#### HL037Pr.1E

Stainless steel grate 115x115mm



#### HL2000KK

trap seal PRIMUS



#### HL01086D

O-ring 88x5mm



#### HL3200

grate frame d 110/100mm/stainless steel frame 121x121mm. System "KLICK-KLACK". Comes with supporting frame/cover.



#### HL01067D

O-ring 92x4mm



#### HL037N.OE

supporting frame/cover 123x123mm



#### HL310NK

floor drain body DN50/75/110 vertical

### attachment



#### HL0510.7EKK

trap seal cartridge



#### HL3127

Stainless steel grate 115x115mm 'Primus Design'



#### HL3210

Extension d 110/100mm, stainless steel frame (V4A) 121x121mm, incl. O-Ring. System "Klick-Klack".



#### HL619

fixing brackets



#### HL840

fire collar R90 for HL310N series



#### HL845

formwork-core with center-ring for HL840

### Alternatives



#### HL310N-3000

floor drain DN50/75/110 vertical, 121x121mm KLICK-KLACK/115x115mm

## extensions



**HL340N**  
extension 80mm/d 110mm incl. O-ring



**HL85N**  
extension with flange incl. O-ring



**HL85NC**  
extension d 110mm CeraDrain with polymer concrete collar incl. O-ring



**HL85NH**  
extension incl. O-ring with bitumen membrane

## Waterproofing Kits



**HL83**  
waterproofing kit with EPDM collar 400x400mm



**HL83.0**  
waterproofing kit



**HL83.H**  
waterproofing kit with bitumen membrane d 400mm



**HL83.M**  
Sealing kit with laminated fleece



**HL83.P**  
waterproofing kit with flange PVC d 287mm

## DOWNLOADS

<b>Foto Print</b>	<b>HL310NPr_3000_pr.tif</b>	max.
<b>Foto Web</b>	<b>HL310NPr_3000_B.jpg</b>	640x480/300dpi
<b>Foto Parts List</b>	<b>HL310NPr_3000_gr.jpg</b>	150x150/72dpi
<b>Techn. drawing</b>	<b>HL310NPR3000_a.pdf</b>	pdf
<b>CAD</b>	<b>310NPR3000_2_a.dxf</b>	dxf
<b>example of use</b>	<b>HL310NPr-3000_PZ.pdf</b>	pdf