

HL5100Pr

Floor drain DN 50/75 horizontal with siphon PRIMUS 145x145 mm Klick-Klack/
138x138mm



Floor drain DN 50/75 horizontal with flange, siphon PRIMUS, works also without water, 8-80 mm grating (may be cut off) with stainless steel frame 145x145mm, Klick-Klack, stainless steel grate 138x138mm, lot cover for body and top



Techn. drawing

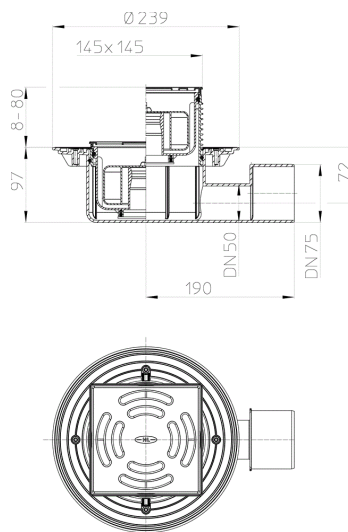

TECHNICAL DATA

material	PE/PP/Edelstahl	installation height	97 mm
dimension	DN50/75	grate frame	8-80 mm/145 x145 mm
capacity	0,8 l/s	grate	Edelstahl 138 x138 mm
weight	1,069	load class	K3 - 300kg

MAIN DATA**spare parts****HL2100**

Siphon PRIMUS for HL3100Pr and HL5100Pr

**HL01093D**

O-ring 125x4

**HL3910Pr**

Grating d 146 mm/ Stainless steel frame 145x145 mm/ Stainless steel grate 138x138 mm, System Klick-Klack, siphon PRIMUS

**HL03910.1E**

Grate stainless steel 138x138mm

**HL03910.2E**

Grating d 146mm / stainless steel frame 145x145mm incl. O-ring, system Klick-Klack

**HL01093D**

O-ring 125x4

**HL03900.0E**

Lot cover 145x145 mm

**HL2100**

Siphon PRIMUS for HL3100Pr and HL5100Pr

**HL01093D**

O-ring 125x4

**HL5100K**

Floor drain body DN50/75 horizontal

attachment**HL03910.3E**

Grate stainless steel 138x138 mm

**HL05100.7E**

Normal siphon complete

**HL0540I**

Stainless steel grate with tile hollow

**HL066C.1E**

Stainless steel grate (V4A) "Cut" 138mm x 138mm

**HL066Q.1E**

stainless steel grate "Quadra" 138x138mm

**HL3928**

Extension "Hamam" d 146mm, stainless steel brass plated frame and grate 145x145mm / 138x138mm, "Klick-Klack"

**HL05100.7E**

Normal siphon complete

**HL2100**

Siphon PRIMUS for HL3100Pr and HL5100Pr

**HL6200**

Sound protection pad 500x500mm

Alternatives**HL5100**

Floor drain DN50/75/ horizontal 145x145 mm Klick-Klack/ 138x138 mm

extensions**HL3400**

Elongation element d 146 mm/ 200 mm incl. O-ring

**HL8500**

Elongation element 200 mm/ d 146 mm with flange and O-ring

**HL8500H**

Extension with bitumen flange for HL3100T and 5100T series

Waterproofing Kits**HL8300**

Sealing set with EPDM-collar 500x500 mm

**HL8300.0**

Sealing set with clamp ring stainless steel

**HL8300.H**

Sealing set with bitumen collar 500x500 mm

**HL8300.M**

Sealing kit with laminated fleece

**HL8300.P**

Sealing kit with solid PP flange d 350 mm

**HL8300.PP**

Sealing kit with solid PVC flange d 350 mm

DOWNLOADS

Foto Print	HL5100Pr_pr.tif	max.
Foto Web	HL5100Pr_B.jpg	640x480/300dpi
Foto Parts List	HL5100Pr_gr.jpg	150x150/72dpi
Techn. drawing	HL5100Pr_1_b.pdf	pdf
CAD	HL5100Pr_2_b1.dxf	dxf
example of use	HL5100Pr_PZ.pdf	pdf