

HL73Pr

Plug-in drain Primus, DN110 (not socket)



Plug-in drain "Primus" to be inserted in pipes DN110 (not socket). To be used for surfaces, which do not need waterproofings, e.g. cellar. Cut the pipe flush with the floor and plug in the drain. With "Primus" trap, stainless steel frame 121 x 121 mm, system "Klick-Klack" and grate 115 x 115 mm. Supporting frame included.



Techn. drawing

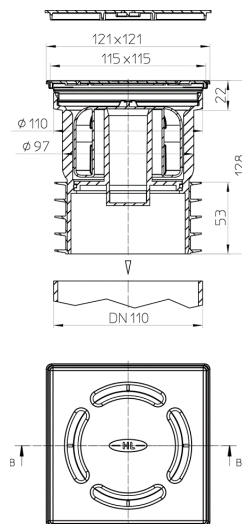

TECHNICAL DATA

material	PP / Edelstahl V2A	installation height	
dimension	DN110 mm	grate frame	121x121mm
capacity	0,46 l/s	grate	Edelstahl 115x115mm
weight	0,457	load class	K - 300 kg

EAN

9003076032327

inlet

standards

MAIN DATA

spare parts



HL037N.OE

supporting frame/cover 123x123mm



HL037Pr.1E

Stainless steel grate 115x115mm



HL073.1E

Trap Primus for plug-in drain HL73Pr

DOWNLOADS

Foto Print	HL73Pr_pr.tif	max.
Foto Web	HL73Pr_B.jpg	640x480/300dpi
Foto Parts List	HL73Pr_gr.jpg	150x150/72dpi
Techn. drawing	HL73Pr-0001_a.pdf	pdf
CAD	HL73Pr_2_a.dxf	dxf
example of use	HL73Pr_PZ.pdf	pdf