

LP389 Large tolerance tapping saddle with BSP threaded outlet







For PE, PVC, cast iron, steel, fibre cement pipes (refer to field of application) DN40 to 300

PRODUCT DESCRIPTION

Universal design

- > Rationalizes the saddle's structure
- > Optimizes the tightening strength
- > Perfect adhesion between the saddle and the pipe

Field of application

	Ductile cast iron Grey cast iron		PE80 PN16
	Steel and coated steel Fibre cement		PE100 PN16 and 12,5
			PVC PN16 and 25

 * For thin-wall pipes : P tapping saddles required.

Guaranteed leakproofness between saddle and pipe thanks to the safety gasket in the outlet

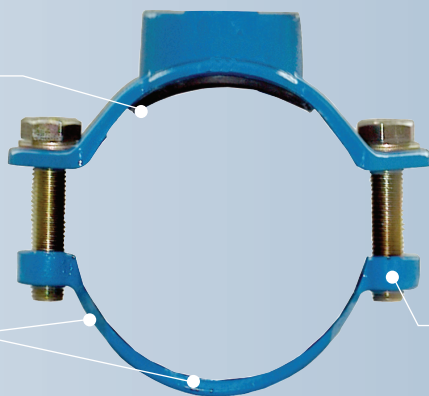

Product

Anti-corrosion,
300µm epoxy coating

Female threaded lug
= only 1 wrench needed.
No galling risk.
Available with SS screws

TOLERANCE INDICATION ON THE LOWER HALF OF THE SADDLE

ZOOM

Gasket detail



Safe installation: the crossbars spread the tightening stress over the whole saddle width

Torque wrench check.
Torque indication on the label

Easy assembling with two screws only.

No metal ring needed

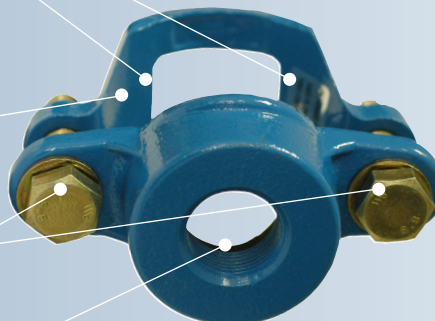

Important...

- > Large tolerance BSP threaded saddle for rigid pipes in particular
- > Gasket for complete watertightness between pipe and saddle
- > Stock rationalization thanks to broad use range
- > OD 32 to 300 mm

EPOXY
300
micron

PRESSURE
16
BAR

ONLY ONE
WRENCH
X1 

MADE
IN
FRANCE 

Large tolerance tapping saddle with BSP threaded outlet

For PE, PVC, cast iron, steel, fibre cement pipes (refer to field of application) DN40 to 300

LP389

TECHNICAL SPECIFICATIONS

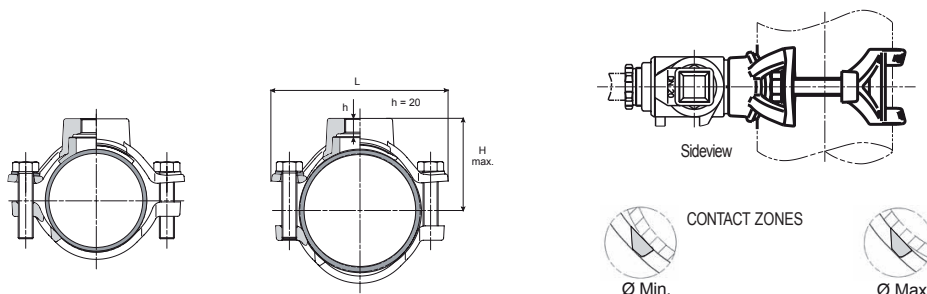

Code		DN	Thread Ø (inch)	Range OD (mm)	L (mm)	H max. (mm)	Weight (kg)	Galvanized Screw - Size
Stand. screws	SS screws							
389.2640	389.2640I	40	1"	48-60	134	57	1,000	M16x65
389.3340	389.3340I		1 1/4"					
389.2650	389.2650I	50	1"	59-71	144	67,5	1,170	M16x65
389.3350	389.3350I		1 1/4"					
389.4050	389.4050I		1 1/2"					
389.5050	389.5050I		2"					
389.2665	389.2665I	65	1"	69-88	148	76	1,120	M16x65
389.3365	389.3365I		1 1/4"					
389.4065	389.4065I		1 1/2"					
389.5065	389.5065I		2"					
389.2680	389.2680I	80	1"	88-109	163	86,5	1,250	M16x65
389.3380	389.3380I		1 1/4"					
389.4080	389.4080I		1 1/2"					
389.5080	389.5080I		2"					
389.26100	389.26100I	100	1"	107-128	186	96	1,350	M16x70
389.33100	389.33100I		1 1/4"					
389.40100	389.40100I		1 1/2"					
389.50100	389.50100I		2"					
389.26125	389.26125I	125	1"	132-152	210	108	1,400	M16x80
389.33125	389.33125I		1 1/4"					
389.40125	389.40125I		1 1/2"					
389.50125	389.50125I		2"					
389.26150	389.26150I	150	1"	158-182	240	123	1,480	M16x80
389.33150	389.33150I		1 1/4"					
389.40150	389.40150I		1 1/2"					
389.50150	389.50150I		2"					
389.26175	389.26175I	175	1"	192-207	265	135	1,920	M16x100
389.33175	389.33175I		1 1/4"					
389.40175	389.40175I		1 1/2"					
389.50175	389.50175I		2"					
389.26200	389.26200I	200	1"	217-234	292	149	2,140	M16x100
389.33200	389.33200I		1 1/4"					
389.40200	389.40200I		1 1/2"					
389.50200	389.50200I		2"					
389.26225	389.26225I	225	1"	240-267	325	165	2,280	M16x120
389.33225	389.33225I		1 1/4"					
389.40225	389.40225I		1 1/2"					
389.50225	389.50225I		2"					
389.26250	389.26250I	250	1"	270-288	346	176	2,460	M16x120
389.33250	389.33250I		1 1/4"					
389.40250	389.40250I		1 1/2"					
389.50250	389.50250I		2"					
389.26275	389.26275I	275	1"	292-311	369	187	2,640	M16x120
389.33275	389.33275I		1 1/4"					
389.40275	389.40275I		1 1/2"					
389.50275	389.50275I		2"					
389.26300	389.26300I	300	1"	311-336	394	187	2,780	M16x120
389.33300	389.33300I		1 1/4"					
389.40300	389.40300I		1 1/2"					
389.50300	389.50300I		2"					

Saddles halves	ductile cast iron according - EN 1563
Outlet	BSP thread according to ISO 228-1
Gasket	EN 681-1 rubber - for fluid temperatures below 40°C
Screws	bichromated zinc coated steel according NF EN ISO 401X / variant : SS A2 (304)
Coating	epoxy, average thickness 300 micron

Strength test to HUOT specifications: 150Nm. Leakproof and depressurization test according to EN 12842 with bolts tightened at 30 and 50 Nm. Corrosion resistance test according to ISO 9227:1991. Test certificates in accordance with current standards are available on request.

All our products are recyclable

